



**Remote  
Control**

## TECHNICAL SPECIFICATION

Max input pressure		100
Max back pressure (tank)	bar	3
Oil input capacity	L min <sup>-1</sup>	15
Oil temperature range	°C	-20 +80
Viscosity range	cSt	10-300
Recommended filtration degree	μ ass	25
Approximate weight	kg	2,2

## CHARACTERISTIC CURVE

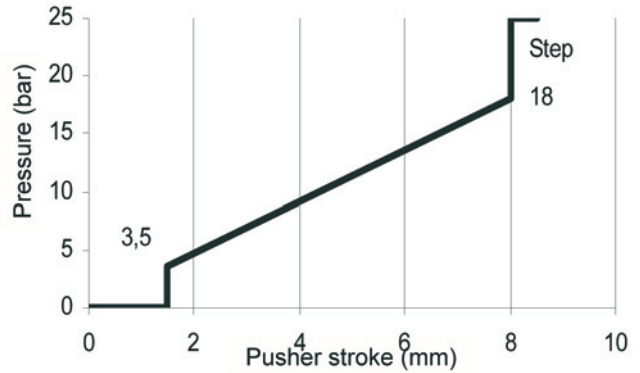

## DRAWINGS

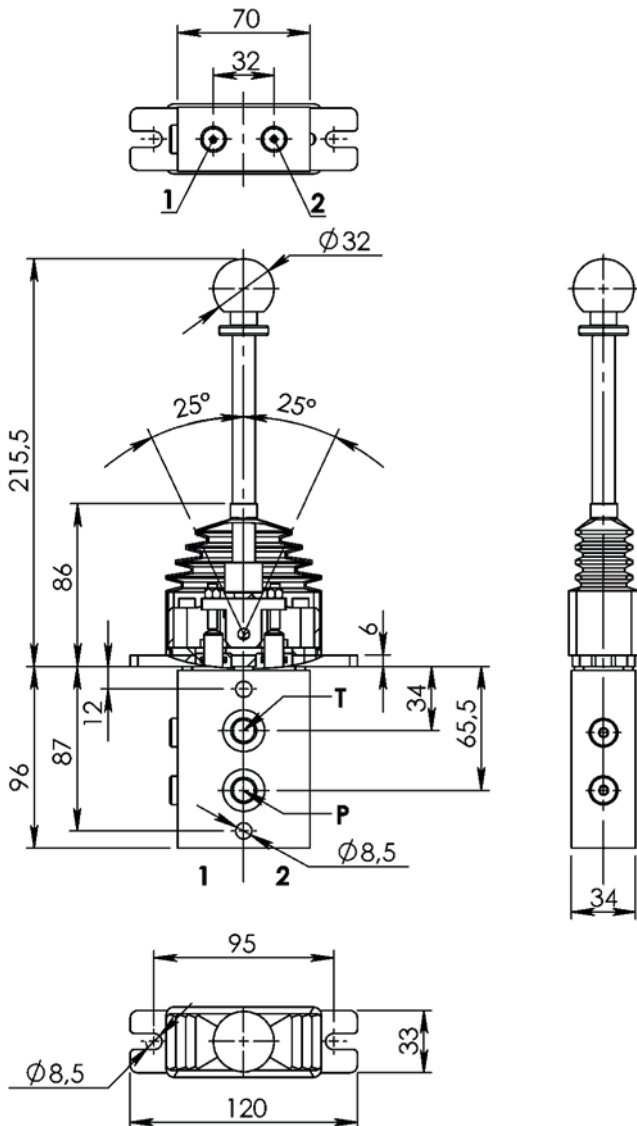

## OPTIONS

- Friction
- Security in neutral
- Sensor in neutral position

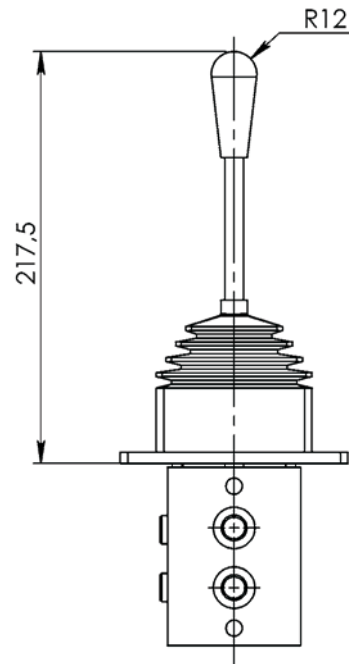

Spring return to neutral version w/o security in neutral

## Materials

Body	Cast iron
Pusher	Stainless steel
Guide	Brass

Information contained in this catalogue is accurate as of the publication date and is subject to change without notice. Performance values are typical values. Customers are responsible for selecting products for their applications using normal engineering methods.



# SMIT

hydraulics

**SMIT Hydraulics**

**Via Pietro Giardini, 318**  
**41100 Modena - ITALY**

[info@smithydraulics.it](mailto:info@smithydraulics.it)  
[www.smithydraulics.it](http://www.smithydraulics.it)

**PHONE**

+39 059 596 77 44  
+39 059 596 77 45

**FAX**

+39 059 596 08 80  
+39 059 596 08 88

**(Domestic market)**

**(International market)**